



Portable  
Oxygen  
Concentrator

# Kingon P2

Breathe Free, Walk With You



# Portable Oxygen Concentrator





**Lightweight@1.98kg**

**NO Heavy Tanks**

**NO Heavy Carts**

**Adjustable Breath Sensitivity**



**PSA  
TECHNOLOGY**



**$O_2$  CAPACITY  
EQUIVALENT TO 5L**



**1.98 KG  
LIGHTWEIGHT**



**4 HOURS  
BATTERY RUN TIME**

# PRODUCT FEATURES

01

1.98kg/4.37 pounds,  
Smallest and Lightest  
1L-Oxygen concentrator in the world.

02

Equivalent to 5 Liters

03

2.8 inch large color display screen.  
From 1- 5 setting flows,  
can meet different oxygen demand.



Portable  
Oxygen Concentrator



04

From 1-5 setting flows,  
can meet different  
oxygen demand.

Setting 1	210ml/min
Setting 2	420ml/min
Setting 3	630ml/min
Setting 4	840ml/min
Setting 5	1000ml/min

05

Rechargeable battery,  
Car charging & AC charging.



Kingon P2 is equivalent to 5 liter

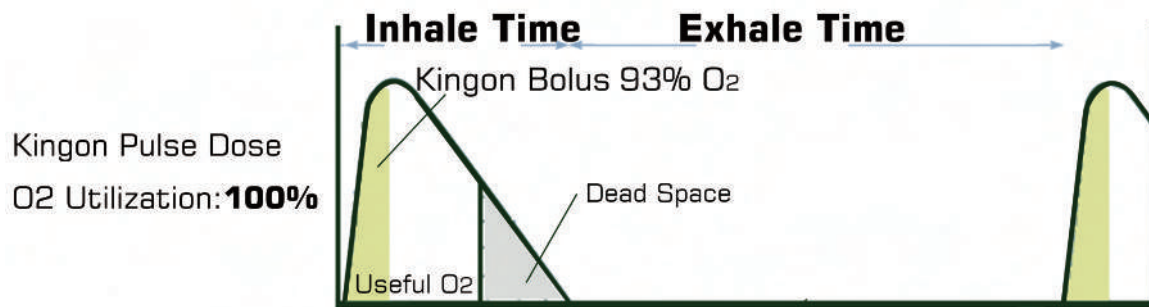

Continuous *VS* Pulse Flow

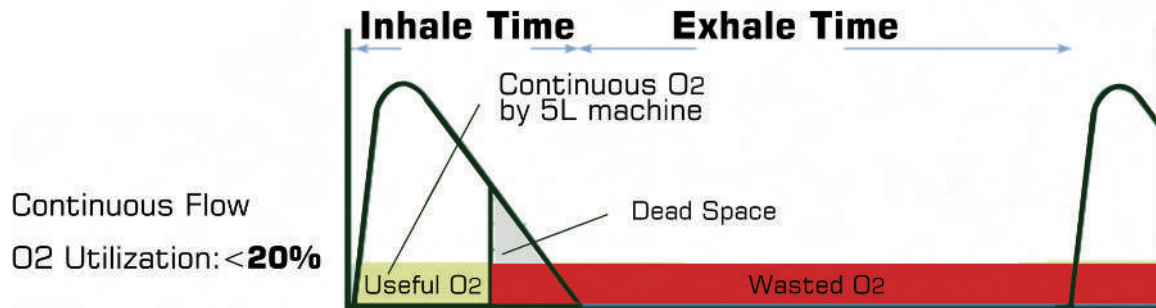

Pulse Dose is based on breathing and inhaling, which is more sophisticated.

Pulse Dose mechanisms are more sensitive, utilizing an oxygen conserver and other technology to deliver oxygen based on breathing rates and other factors.

Kington P2 is with  $\leq 0.12 \text{ cm H}_2\text{O}$  Trigger sensitivity, which is the most dependable and Sensitive portable oxygen concentrator in the world.

Continuous Flow is delivered at a constant rate indiscriminate of the user's breathing.

you can see from the figure that , only 1/6 oxygen can be effectively exchanged on the lung during a Inhale-exhale cycle ,the rest 5/6 oxygen will be wasted in the respiratory tract and exhaling time.

Deliver oxygen	Oxygen utilization rate	Irritation to nose
Based on breathing and inhaling	100%	Less

Pulse Dose

VS

Continuous flow

Deliver oxygen	Oxygen utilization rate	Irritation to nose
Constantly	<20%	More

# PRODUCT INTRODUCTION

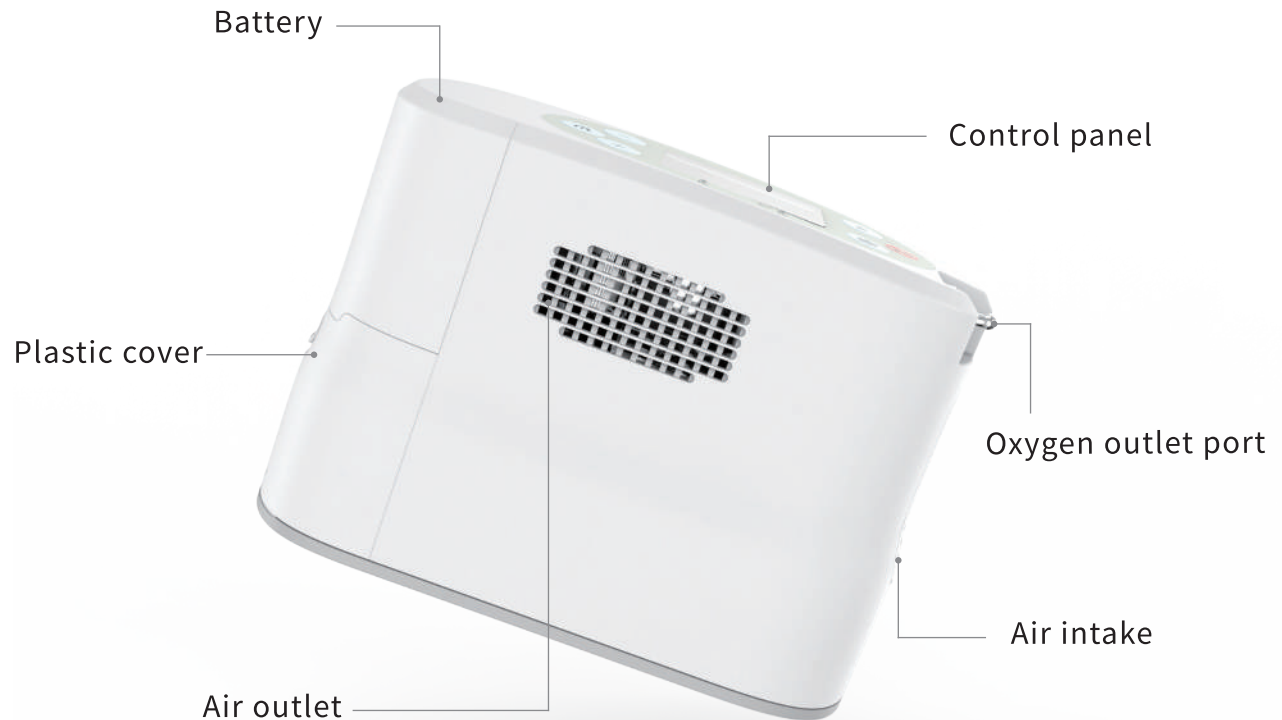



# USER CONTROL

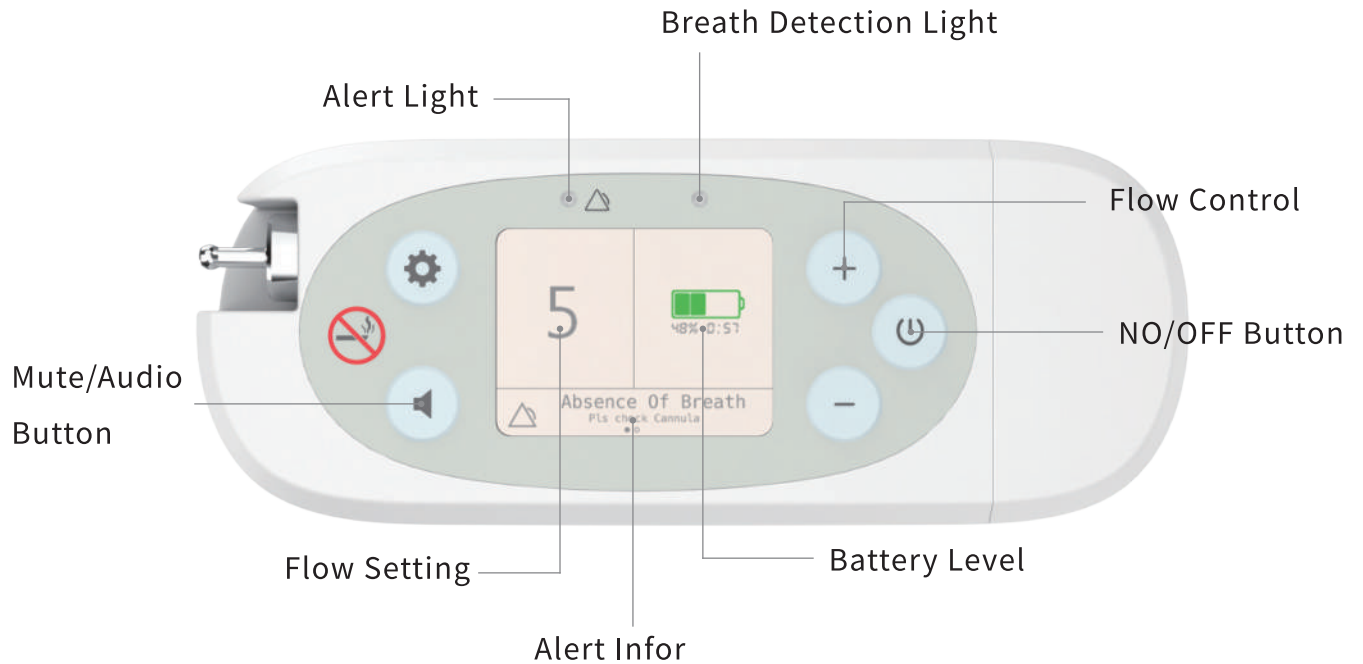

# BATTERY

8 cell standard Battery Up to 4 hours  
Run Time Included with System.



Setting flow / battery duration	1: 3h40min
	2: 3h20min
	3: 2h54min
	4: 2h14min
	5: 1h50min

**MODEL**  
**# BA-P200**

# EXTERNAL BATTERY CHARGER

when the battery is set correctly ,  
a solid red LED will indicate that the  
battery is charging.

when the green light illuminated,  
the battery is fully charged

**MODEL # BA-P203**



# ACCESSORIES



Carry Bag

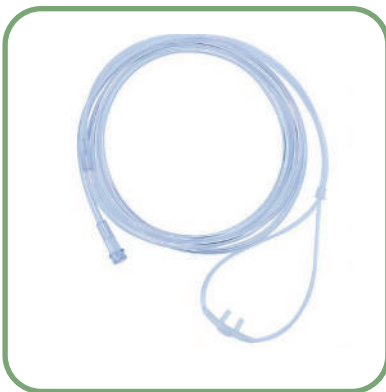

Nasal Cannula



Battery



AC Adapter



DC Adapter

# PRODUCT SPECIFICATION

Oxygen Concentration	90%-3%/+6% at all settings
Oxygen Flow Max	1 Liter/min, equivalent to 5 Liters
Warm-Up Time	2 minutes
Weight	4.37 lbs. 1.98 kg ( includes battery)
Size	Length: 8.70" ( 221mm )
	Width: 6.30" (160mm )
	Height: 3.35" ( 85mm ) (includes battery)
Oxygen Flow	Pulse dose delivery system
	Five flow settings 1, 2, 3, 4, 5
Power	AC Power Supply 100-240V, 50-60Hz
	(auto sensing to allow worldwide use)
	DC Power Adapter: for mobile use in car
Battery	Duration : Up to 4 hours
	Recharge not more than 4 hours with AC or DC power
Noise Level	49 Decibels* @setting 2
Display Screen	2.8 inch
Warranty	3 year of warranty(Excluding Battery & Sieve Bed)
Operation	Simple control functions and easy-to-read LCD display
Use	Designed for 24/7 use





# About Kingon

Qingdao Kingon Medical Science and Technology Co.,Ltd,  
has been concentrating on the research and development of portable oxygen concentrator for 2 years.

With powerful research and development team,a first-class laboratory equipment and abundant capital,Kingon has produced a portable oxygen concentrator-- P2, it is the smallest and lightest in the world of 1L-Oxygen Concentrator.

Kingon,based on the principles of" Breathe Free Walk With YOU",focus on customer needs,offer patients a helpful oxygen therapy and enhance their life quality.

In the future,we will be still in technically constant innovation,improve the quality of the products and service,the expectation and demand that are devoted to content with our client.Kingon is energetic and creative.We are based on the domestic market,and actively explore global business We are willing to cooperate with distributors from all over the world,accept multiple ways of cooperation,ODM,OEM.

We look forward to cooperating with you!

# kingon

Qingdao Kingon Medical Science and Technology Co., Ltd

ADD:

24th East Building ,No.252 Yanhe Road ,Tianhe Industrial Park,  
Huangdao,Qingdao,Shandong , China, 266510

Irene Han

E-mail: [kingonmed@gmail.com](mailto:kingonmed@gmail.com)

Tel: 0086 532 86767095 // 0086 532 58792324

M: 0086 137 8064 1817 (as whatsapp&wechat)

[www.kingonmed.com](http://www.kingonmed.com)

